

PLOT NO. 111

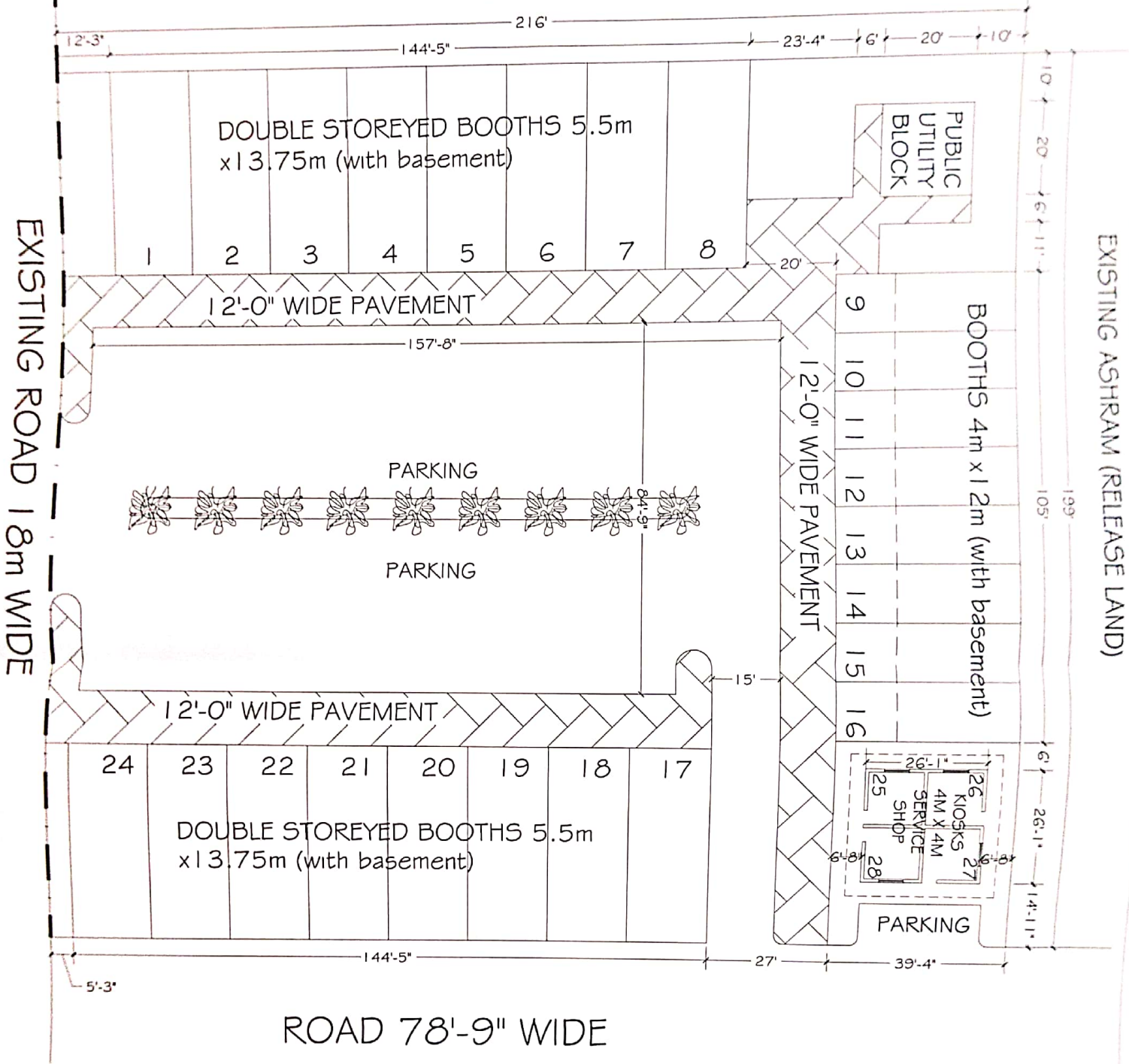

EXISTING ASHRAM (RELEASE LAND)

EXISTING ROAD 18m WIDE

ROAD 78'-9" WIDE

**HSIIDC**  
**I.E. FARIDABAD**  
**SECTOR-59**  
**PLAN OF CONV. SHOPPING**

DETAIL OF BOOTHS & KIOSKS

Sl. No.	Booths / Kiosks	Area (sq. m)	Total
1	16 x 24 = 384	384	
2	17 x 11 = 187	187	
3	17 x 11 = 187	187	
TOTAL		758	

DETAIL OF AREA

Area Description	Area (sq. m)
TOTAL AREA OF SITE	1271.68
AREA UNDER 5.5m x 13.75m DOUBLE STOREYED BOOTHS	1271.68
AREA UNDER 4m x 12m BOOTHS	433.74
AREA UNDER KIOSKS 4m x 4m SERVICE SHOP	196.33
AREA UNDER PUBLIC UTILITIES BLOCK	46.96
AREA UNDER PARKING, PAVEMENTS & GREEN ETC.	231.72

THIS DRG. WILL SUPERCEDES THE ALREADY APPROVED DRG. No. HSIIDC/FPD/835, Dated : 12/12/13  
 Drg. No. HSIIDC/FPD/999, Dated : 16.10.15

DRAWN BY:- MANOJ KUMAR (SD-)

P.O:- SURINDER PRASHAR (SD-)

A.T.P:- POOJA (SD-)

D.T.P:- DEVENDER PAL (SD-)

C.T.P:- ARVIND MEHTANI (SD-)

VINEET GARG (SD-)  
 DIRECTOR CONTROLLED AREA CUM M.D. (HSIIDC-)